

Metal-Enclosed Limit Switches

D

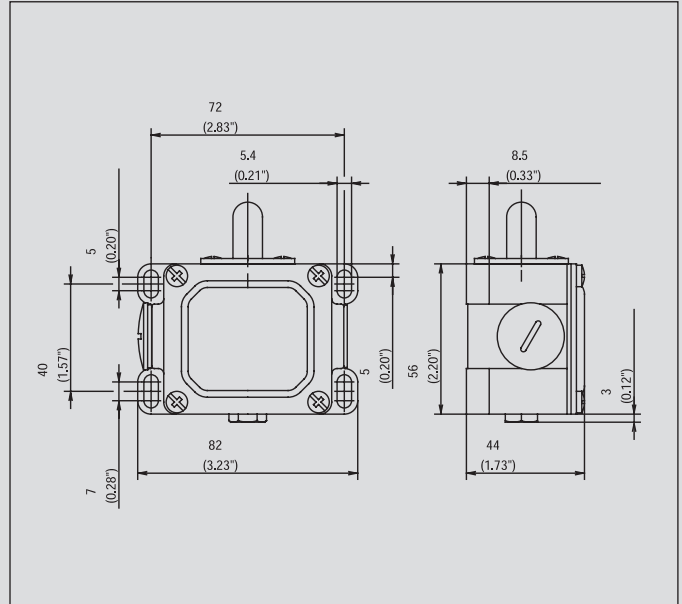

Recommended use

Heavy duty enclosure for harsh operating conditions with particularly tough design of actuator and switching systems.

Product advantages

- Protection class IP 65 to VDE 0470 T1
- Enclosure: Aluminium pressure die-casting
- Cover: Sheet aluminium
- Actuator can be repositioned by 4 x 90° (depending on type)
- Cable entries 2x M20 x 1.5
- Connection designation conforming to DIN EN 50013
- Sturdy contacts
- Hard wearing guide bushes

Options

- AS interface versions on request
- Preassembled with customer-specific cables and connectors on request

Design layout

- Slow-action and snap-action contacts
- Versions: 1 NC / 1NO, 2 NC, 2 NO, 3 NC, 3 NO, overlapping contacts
- All NC contacts with ⊕ in the circuit diagram are positively opening contacts
- Latching function on request

Mounting

- 4 slots for M5 screws

Installation advantages

- 2 cable entries for through-wiring
- Generously dimensioned connection space
- Captive cover screws

Technical data

Electrical data	
Rated insulation voltage	U _i max. 400 V AC
Conventional thermal current (up to) ^①	I _{the} 10 A
Rated operating voltage	U _e max. 240 V
Utilization category	AC-15, U _e /I _e 240 V/3 A
Short-circuit protection (up to) ^①	Fuse 10 A gL/gG
Protection class	I
Mechanical data	
Enclosure material	Aluminium pressure die-casting
Ambient temperature	-30 °C to + 80 °C
Mechanical service life	10 x 10 ⁶ switching cycles
B10d	20 Mill.
Switching frequency	≤ 100/min.
Type of connection	Screw connections
Conductor cross sections	Single-wire 0.5 – 1.5 mm ² or Stranded wire with ferrule 0.5 – 1.5 mm ²
Cable entry	2 x M20 x 1.5
Protection class	IP 65 conforming to IEC/EN 60529
Standards	
VDE 0660 T100, DIN EN 60947-1, IEC 60947-1 VDE 0660 T200, DIN EN 60947-5-1, IEC 60947-5-1	

^① Depending on switching system. See Table on Pages 70 – 73.

W

RW

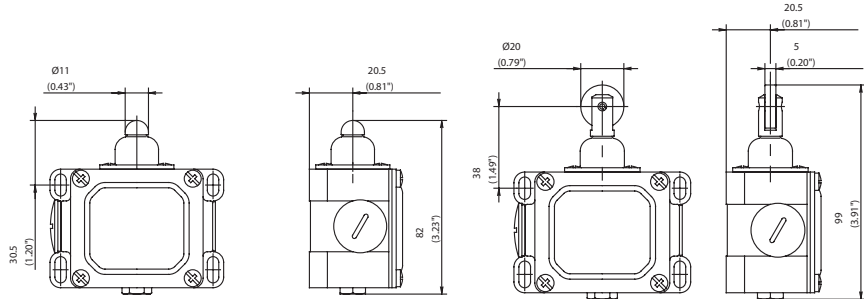

Switching operation

Slow-action

Snap-action

Slow-action

Snap-action

1 NC / 1 NO contact

6041103002
D-U1 W

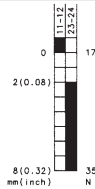

6041153156
D-SU1 W

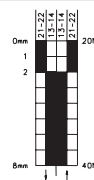

6041182229
D-U1Z RW

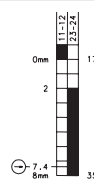

6041168162
D-SU1 RW

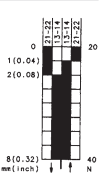

2 NC contacts

6041803090
D-A2 W

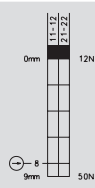

6041818741
D-A2Z RW

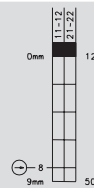

2 NO contacts

6041803046
D-E2 W

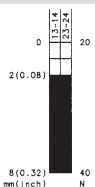

6041818052
D-E2 RW

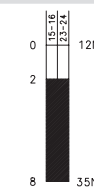

1 NC / 1 NO contact
Overlapping

6041303134
D-UV1Z W

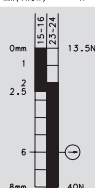

6041318140
D-UV1Z RW

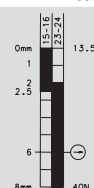

Approvals



Replacement actuator: -

Replacement actuator: -

Special features / variants
(on request)

- Also available with following contacts:
 - 3 NC contacts
 - 3 NO contacts
 - 2 NC / 2 NO contact (larger enclosure)

Special features / variants
(on request)

- Available for high temperature range
- With following contacts:
 - 3 NC contacts
 - 3 NO contacts
 - 2 NC / 2 NO contact (larger enclosure)

AH

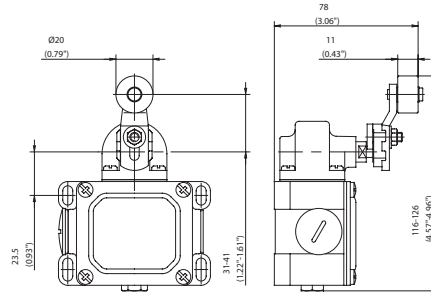

HW

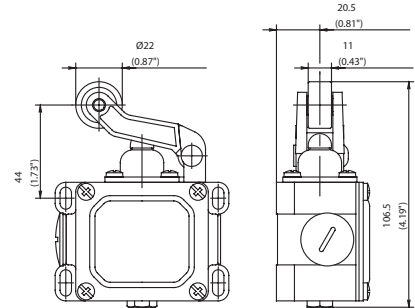

Switching operation

1 NC / 1 NO contact

Slow-action

6041135019
D-U1 AH

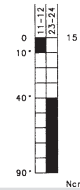

Snap-action

6041185173
D-SU1 AH

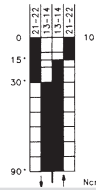

Slow-action

6041121010
D-U1 HW

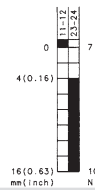

Snap-action

6041171164
D-SU1 HW

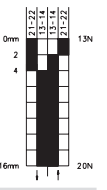

2 NC contacts

6041835107
D-A2 AH

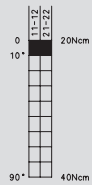

2 NO contacts

**1 NC / 1 NO contact
Overlapping**

6041321142
D-UV1Z HW

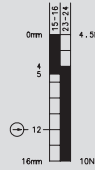

Approvals



Replacement actuator: 3914350924

Replacement actuator: 3914211065

Special features / variants
(on request)

- With steel roller, various roller diameters
- Cranked or straight lever
- Different lever lengths
- Also available with following contacts:
3 NC contacts
2 NC / 2 NO contact

Special features / variants
(on request)

- Available for high temperature range
- With following contacts:
3 NC contacts
2 NC / 2 NO contact
(larger enclosure)

PW

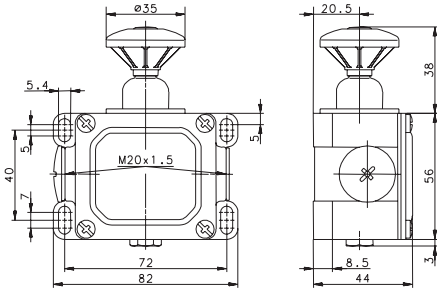

Slow-action

6041113006
D-U1 PW

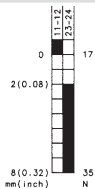

6041813835
D-A2Z PW

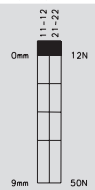

Replacement actuator: –

Special features / variants
(on request)

- Also available with following contacts:
 - 3 NC contacts
 - 3 NO contacts
 - 2 NC / 2 NO contact
 - (larger enclosure)